

Beehive Sports Pitches

Chilomoni, Blantyre

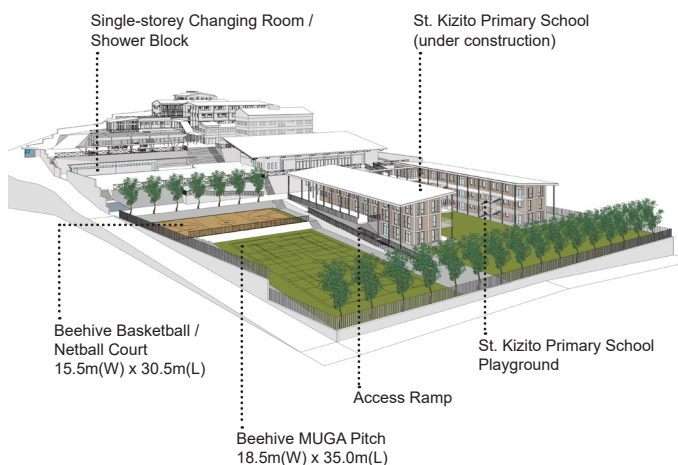

Location

Beehive Main Campus, Chilomoni, Blantyre, Malawi

Type

Sports Pitches and Changing Accommodation

Year of Construction

To be confirmed

Concept Design Architect

Julianne Cassidy

Total Development Area (Approx. GEA)

1902m² for Sports Pitches

115m² for Changing Rooms/Showers

Number of Storeys

0 for Sports Pitches

1 for Changing Rooms/Showers

Construction Cost

Estimated 70,866,705 MWK Ground Works and Levelling

Estimated 73,207,147 MWK for Sports Pitch urfacing and Lighting

Estimated 29,440,000 MWK for Changing Roms/Showers

Estimated 173,533,852 MWK TOTAL

(£174,558 GBP - rate correct as of 24th August 2020)

Cost per m²

Estimated 75,749 MWK / m² for Sports Pitches

Estimated 115m² @ 256,000 MWK / m² for Changing Roms/Showers

“The community will benefit greatly, especially vulnerable children, in developing physical and psycho-social skills... confidence, decision-making, problem-solving and other important life skills will be enhanced.” (Limbani Njewa, MTCC Extended Schools Leader)

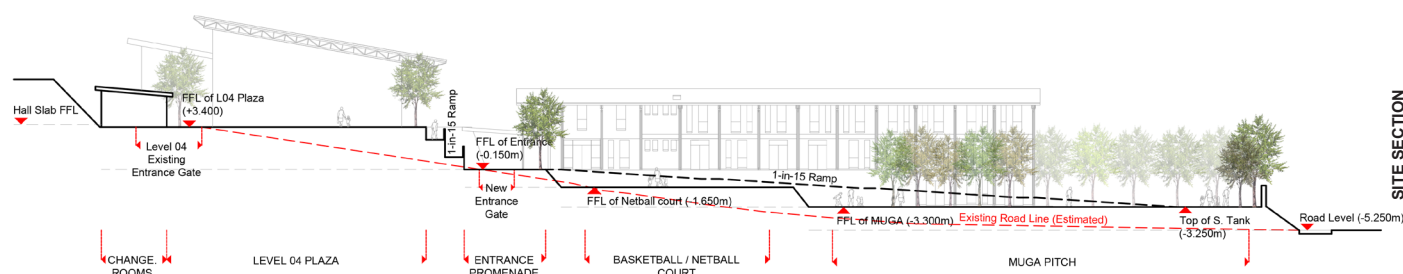

“Facilities that provide recreation, cultural and sporting activities help to keep young people busy and occupied... however, a quick availability assessment shows that there is a serious inadequacy for these structures. Where these are available, they are either in a dilapidated state or are largely inaccessible by the youth.”
 (‘National Youth Policy’, Government of Malawi, 2013)

The Beehive Sports Pitches will be constructed at the Beehive Main Campus, in Chilomoni, Blantyre, and will serve the St. Kizito Primary School, the MTCC Extended Schools Sports team, a future Secondary school, and - outside of school hours - the local community. It will become an important resource for the local community, providing much-needed designated space in a very densely built-up area for sports education and community sporting activities and events.

Set on a sloped site, the Sports Pitches will comprise two levels; the top level will accommodate a full-size pitch for Basketball and Netball (Netball being the most popular women’s sports in Malawi,

with Malawi’s national women’s team currently sitting 6th in the International Netball Federation rankings) and the bottom level will accommodate a ‘MUGA’ (Multi-Use Games Area) suitable for Football, Ruby, Cricket, Tennis, Netball, Badminton, Basketball and Athletics. Both pitches will be sized to international recommendations. A small 1.5m-high revetment wall, faced with local stones, will take up the height difference between the two levels. Directly adjacent to the MUGA, simple ‘tiers’ will be cut into the existing ground, and topped with lawn, providing basic spectator seating for larger events. An external ramp to the East of the Pitches (shared with the Adjacent St. Kizito Primary School) will provide step-free access between the two levels, ensuring that the facility is inclusive to all.

An important part of the Sport Pitches provision will be the construction of the Changing Room block. The block will be a simple, single-storey building and will provide separate changing and shower facilities for boys and girls; this building will be pivotal in ensuring that young girls in particular are included in PE lessons and extra-curricular sporting activities

Wellbeing

will be enhanced through physical activity, teamwork and community events.



There is the potential for the Extended Schools Sports Team to

double with the expanded facilities



Spiritual Wellbeing

480 St Kizito primary school pupils will have access to high quality sports education



Job Creation

21,000

local children will benefit from access to sports through curriculum and extra-curricular activities



Quality Education

Supporting the Vulnerable

Social Impact

The new sports pitches will create a much-needed hub for children's sport in Chilomoni. Not only will it provide high quality facilities for PE lessons at St Kizito Primary School, but it will enable Beehive's existing, over-subscribed 'Extended Schools Sports Programme' to expand and reach more children within the community. The current programme works with 3000 children, and the new pitches will allow us to reach all 21,000 Chilomoni children. The pitches will enable the team to build upon their existing sports. Currently they have established clubs in football, netball, cricket, athletics and biking, at both Beehive and surrounding schools. The new facilities provide space for additional sports, such as basketball, tennis and rugby. Extending the provision of after-school activities will help occupy the local children, and discourage them from partaking in anti-social behaviour. Through the current programme local talent has been recognised, with members of the cricket team being accepted at the Blantyre cricket academy and 4 netball players have received scholarships at a local private school. We are confident more opportunities will be created through the new pitches.

"I have developed a good behavior and have been preventing bad behaviors such as sexual activities, smoking Indian hemp and beer drinking and got free education at Joyce Banda Foundation as an achievement."

(Girls consultation - Participants answer to the question 'How has sports helped you in other areas of your life?')

